

RESOURCE GROUP FORM
FLORIDA MASTER SITE FILE
Version 4.0 1/07

Site #8 BR01987
Field Date 4-12-2010
Form Date 4-11-2011
Recorder#

Original
Update

NOTE: Use this form to document districts, landscapes, building complexes and linear resources as described in the box below. Cultural resources contributing to the Resource Group should also be documented individually at the Site File. Do not use this form for National Register multiple property submissions (MPSs).

Check ONE box that best describes the Resource Group:
Historic district
Archaeological district
Mixed district
Building complex
Designed historic landscape
Rural historic landscape
Linear resource

Resource Group Name Shuttle Landing Facility Runway Multiple Listing [DHR only]
Project Name HAER Documentation-Shuttle Landing Facility FMSF Survey #
National Register Category (please check one): building(s) structure district site object
Linear Resource Type (if applicable): canal railway road other (describe):
Ownership: private-profit private-nonprofit private-individual private-nonspecific city county state federal Native American foreign unknown

LOCATION & MAPPING

Street Number Direction Street Name Street Type Suffix Direction
Address: Kennedy Space Center
City/Town (within 3 miles) Titusville In Current City Limits? yes no unknown
County or Counties (do not abbreviate) Brevard
Name of Public Tract (e.g., park)
1) Township 21S Range 36E Section 27, 34 1/4 section: NW SW SE NE Irregular-name:
2) Township 21S Range 36E Section 35 1/4 section: NW SW SE NE
3) Township 22S Range 36E Section 2, 11 1/4 section: NW SW SE NE
4) Township Range Section 1/4 section: NW SW SE NE
USGS 7.5' Map(s) 1) Name WILSON USGS Date 1949
2) Name ORSINO USGS Date 1976
Plat, Aerial, or Other Map (map's name, originating office with location)
Landgrant
Verbal Description of Boundaries (description does not replace required map) The boundaries of this resource group are the edges of the runway, inclusive of the shoulders and overruns.

DHR USE ONLY OFFICIAL EVALUATION DHR USE ONLY
NR List Date SHPO - Appears to meet criteria for NR listing: yes no insufficient info Date Init
KEEPER - Determined eligible: yes no Date
Owner Objection NR Criteria for Evaluation: a b c d (see National Register Bulletin 15, p. 2)

HISTORY & DESCRIPTION

Construction Year: 1976 [X]approximately []year listed or earlier []year listed or later
Architect/Designer(last name first): Greiner Engineering Builder(last name first): Morrison-Knudsen, Inc
Total number of individual resources included in this Resource Group: # of contributing 1 # of non-contributing 0
Time period(s) of significance (choose a period from the list or type in date range(s), e.g. 1895-1925)
1. Other 3.
2. 4.
Narrative Description (National Register Bulletin 16A pp. 33-34; fit a summary into 3 lines or attach supplementary sheets if needed) see attached

RESEARCH METHODS (check all that apply)

- [X]FMSF record search (sites/surveys) [X]library research []building permits []Sanborn maps
[]FL State Archives/photo collection []city directory [X]occupant/owner interview []plat maps
[]property appraiser / tax records [X]newspaper files []neighbor interview []Public Lands Survey (DEP)
[X]cultural resource survey [X]historic photos [X]interior inspection []HABS/HAER record search
[]other methods (specify)

Bibliographic References (give FMSF Manuscript # if relevant) see attached

OPINION OF RESOURCE SIGNIFICANCE

Potentially eligible individually for National Register of Historic Places? [X]yes []no []insufficient information
Potentially eligible as contributor to a National Register district? [X]yes []no []insufficient information
Explanation of Evaluation (required, see National Register Bulletin 16A p. 48-49. Attach longer statement, if needed, on separate sheet.) see attached

Area(s) of Historical Significance (see National Register Bulletin 15, p. 8 for categories: e.g. "architecture", "ethnic heritage", "community planning & development", etc.)
1. Other 3. Engineering 5.
2. Transportation 4. 6.

DOCUMENTATION

Accessible Documentation Not Filed with the Site File - including field notes, analysis notes, photos, plans and other important documents
1) Document type All materials at one location Maintaining organization Archaeological Consultants Inc
Document description File or accession #'s P9026I
2) Document type Maintaining organization
Document description File or accession #'s

RECORDER INFORMATION

Recorder Name Slovinac, Trish Affiliation Archaeological Consultants Inc
Recorder Contact Information 8110 Blaikie Court, St A, Sarasota, FL 34240/941-379-6206/ACIFloridaAcomcast.net
(address / phone / fax / e-mail)

Required Attachments
1 PHOTOCOPY OF USGS 7.5' MAP WITH DISTRICT BOUNDARY CLEARLY MARKED
2 LARGE SCALE STREET, PLAT OR PARCEL MAP WITH RESOURCES MAPPED & LABELED
3 TABULATION OF ALL INCLUDED RESOURCES (name, FMSF #, contributing? Y/N, resource category, street address or township-range-section if no address)
4 PHOTOS OF GENERAL STREETScape OR VIEWS (Optional: aerial photos, views of typical resources)
Photos may be archival B&W prints OR digital image files. If submitting digital image files, they must be included on disk or CD AND in hard copy format (plain paper is acceptable). Digital images must be at least 1600 x 1200 pixels, 24-bit color, jpeg or tiff.

CONTINUATION SHEET**Narrative Description:**

The Shuttle Landing Facility Runway is one of the longest runways in the world, measuring 15,000 feet in length, with an additional 1000-foot overrun at each end. It is constructed of concrete and has a width of 300 feet and a thickness of 21 inches. There is also a 50-foot asphalt shoulder along each side. The surface slopes at 0.76 degrees from the center line to each edge for run-off purposes. The runway follows a northwest to southeast axis. The original runway, constructed ca. 1976 by Greiner Engineering of Tampa, had a grooved surface. This was found to be damaging to the orbiter's wheels. Therefore, in 1984, 3500 feet at each end of the runway were reconstructed to have a smooth surface to prevent damage.

Explanation of Evaluation:

The Shuttle Landing Facility Runway is considered eligible for listing in the NRHP in the context of the U.S. Space Shuttle Program (1969-2010) under Criterion A in the areas of Space Exploration and Transportation and under Criterion C in the area of Engineering. Because it has achieved significance within the past 50 years, Criteria Consideration G applies. As the primary landing site for the Shuttle Orbiter, the KSC Shuttle Landing Facility Runway is an essential component in the Space Shuttle Program. It is also significant as a practice facility for the astronauts.

The Shuttle Landing Facility Runway is also considered a contributing resource to the Shuttle Landing Facility Area Historic District (8BR1986).

CONTINUATION SHEET

Bibliographic References:

Anonymous. "KSC Complex 39 Reshaped for Role in the Shuttle Era." *Marshall Star*, July 6, 1977: 2.

Archaeological Consultants, Inc. (ACI). *Survey and Evaluation of the Historic Facilities within the Industrial, Launch Complex 39 (LC-39), Vehicle Assembly Building (VAB), and Shuttle Landing Facility (SLF) Areas of the John F. Kennedy Space Center (KSC), Brevard County, Florida, with a Reassessment of the Existing National Register of Historic Places LC-39 Site*, NASA KSC, 1998.

Jenkins, Dennis R. *Space Shuttle, The History of the National Space Transportation System. The First 100 Missions*. Hong Kong: World Print Ltd., 2001.

Liston, Elaine and Dawn Elliott. *History of the Shuttle Landing Facility at Kennedy Space Center*. Proceedings of the 2003 Space Congress, 2003.

National Aeronautics and Space Administration. *America's Spaceport: John F. Kennedy Space Center*, n.d.a

National Aeronautics and Space Administration. *Countdown! NASA Space Shuttles and Facilities*. IS-2005-06-017-KSC, n.d.b

National Aeronautics and Space Administration. *Technical Facilities Catalog* [NHB 8800.5 (II)], March 1967.

National Aeronautics and Space Administration. *Technical Facilities Catalog* [NHB 8800.5A (II)], October 1974.

National Aeronautics and Space Administration. *Space Shuttle Launch Support Equipment Data Handbook*, Engineering Development Directorate, KSC-DD-186 Revision A, March 30, 1993.

National Aeronautics and Space Administration. *Facts: John F. Kennedy Space Center*, 1994.

National Aeronautics and Space Administration. *Basic Information Guide/KSC GP-14-2*, KSC Master Planning, October 2000.

National Aeronautics and Space Administration, Kennedy Space Center, NASA Facts. *Landing the Space Shuttle Orbiter*. FS-2005-08-026-KSC, 2006.

Websites

"Countdown! NASA Launch Vehicles and Facilities, Shuttle Landing Facility." NASA Facts On line. John F. Kennedy Space Center, 2000.
<http://www-pao.ksc.nasa.gov/kscpao/nasafact/count3slf.htm>

"Shuttle Landing Facility (SLF)." <http://science.ksc.nasa.gov/facilities/slf.html>

RESOURCE GROUP FORM
PHOTOGRAPHS

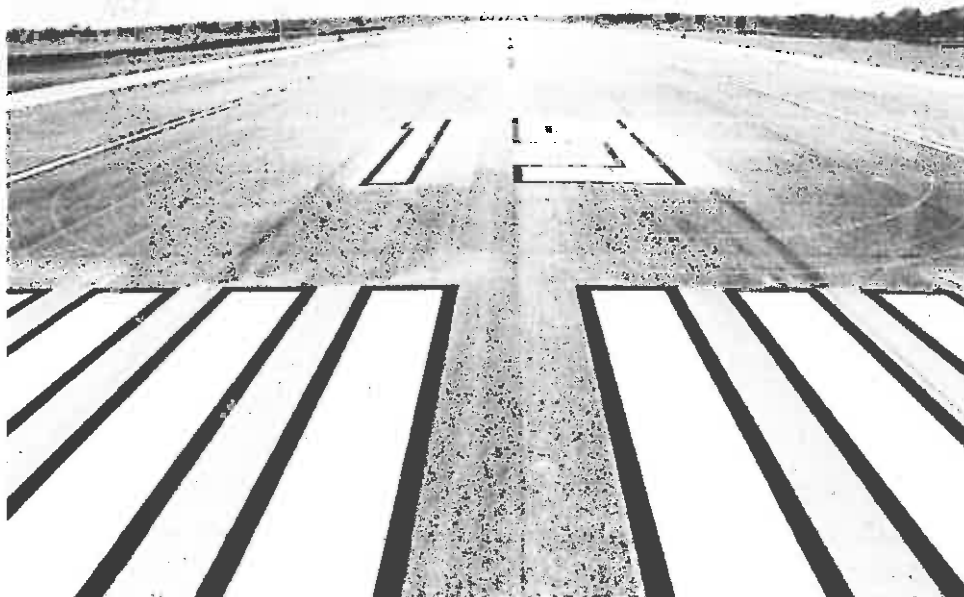

PHOTOGRAPHS

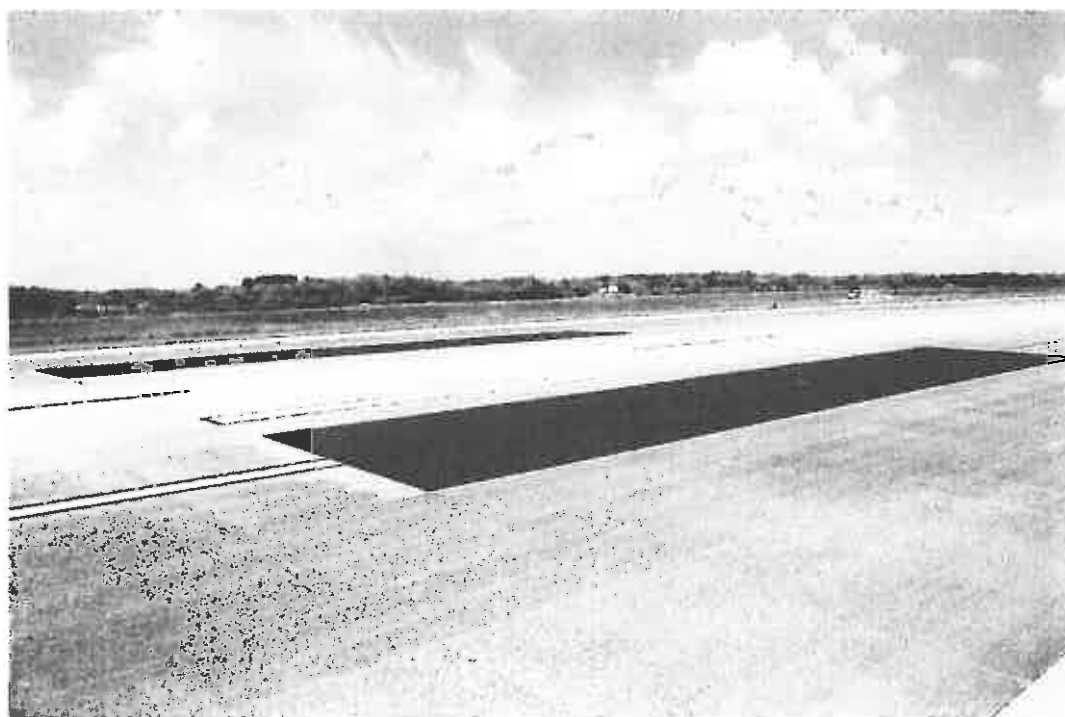
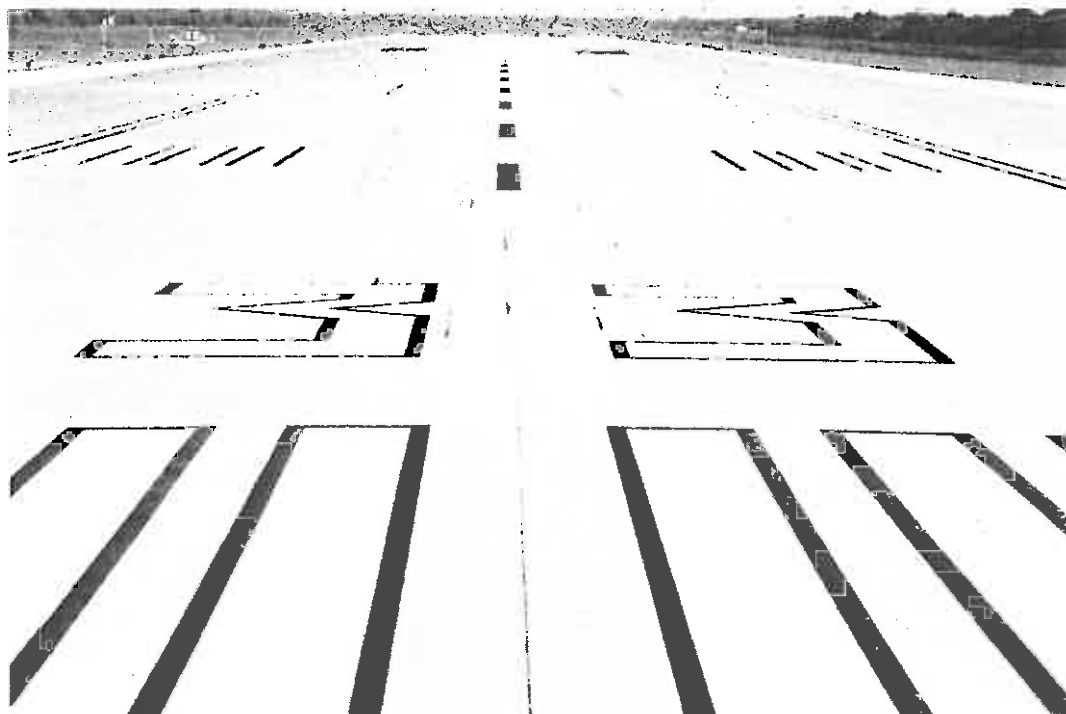

RESOURCE GROUP FORM

PHOTOGRAPHS



STREET OR PLAT MAP

Source: NASA John F. Kennedy Space Center, Facility Utilization Chart, July 1, 1995, Chart B

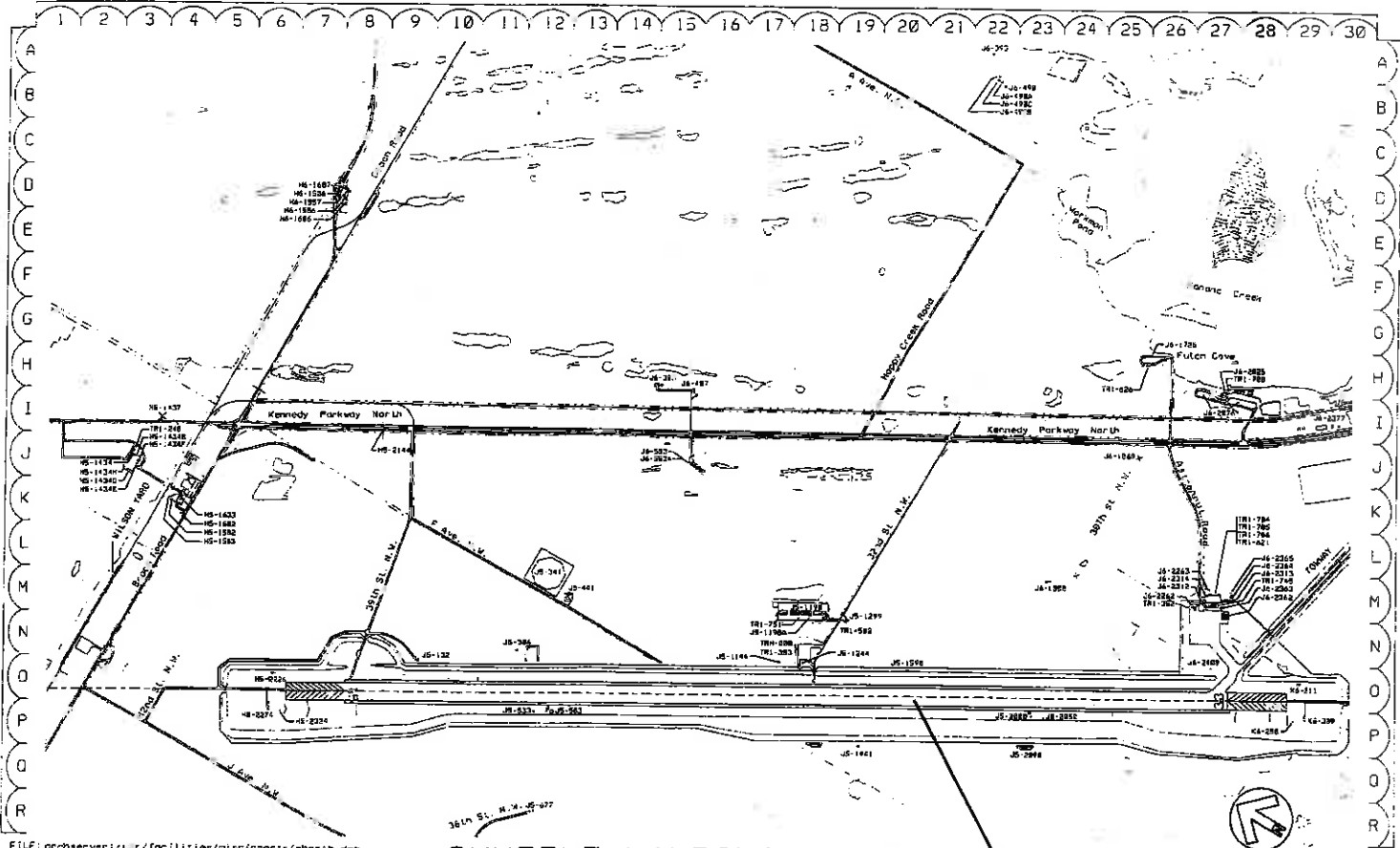

FILE: archserver\usr\facilities\misc\charts\chartb.dgn
DATE: 06/21/95

36th St. N.W. 05-077

SHUTTLE LANDING FACILITY

CHART B

8BR1987
Shuttle Landing Facility
(Runway)

